



1-877-905-SEAL (7325) www.sealandcylinder.com

Specials Notes:

Customer _____
 Application _____

Operating Pressure _____ E =
 Temperature _____ G =
 Operating Medium _____ J =
 Speed _____ A =
 _____ WF =

Dimensions
 LB =
 WF =
 Pin Size =
 Mid Trunnion to
 Rod Shoulder =

Series	Mounting Style	Bore	Stroke	Rod	Style	Cushions	Ports	Seals	Specials
H - High Pressure Hydraulic	MX0 - No Mount	1.5	1 - 300"	0.625	1 (Small Male)	NC (No Cushions)	N (NPT)	P (Polyurethane)	S
LH - Medium Pressure Hydraulic	MX1 - Tie Rod Extend Both End	2		1	2 (Oversize Male)	BE (Both Ends)	S (SAE)	V (Viton)	
A - Heavy Duty Pneumatic	MX2 - Tie Rod Extend Cap End	2.5		1.375	3 (Female)	RE (Rod End)	F (Flange)	B (Buna / Nitrile)	
LA - Light Duty Pneumatic	MX3 - Tie Rod Extend Head End	3.25		1.75	4 (Safety Coupler)	CE (Cap End)			
MH - High Pressure Mill Hydraulic	MPU3 - Self Aligning Eye	4		2	5 (Special)				
SA - Stainless Pneumatic	MT1 - Head Trunnion	5		2.5					
SH - Stainless Hydraulic	MT2 - Cap Trunnion	6		3					
CH - Custom Hydraulic	MT4 - Inter.Fixed Trunnion	7		3.5					
CA - Custom Pneumatic	MP1 - Cap Fixed Clevis	8		4					
	MP2 - Cap Detachable Clevis	10		4.5					
	MP3 - Pivot Eye	12		5					
	MPU3 - Spherical Eye	14		5.5					
	MS2 - Side Lugs	16		6					
	MS3 - Cen.line Lug	18		7					
	MS4 - Side Tapped	20		8					
	MF1 - Rectang.Head Flange	22		10					
	MF2 - Cap Rect.Flange	24							
	MF5 - Head Sq.Flange								
	MF6 - Cap Sq.Flange								
	MS7 - Lug Foot Mount Ends								
	ME3 - Head Square								
	ME4 - Cap Square								
	ME5 - Flange Head								
	ME6 - Flange Head								
	DRE - Double Rod End								

Special Cylinder Modifications

- | | |
|---------------------------|-------------------------------------|
| Air Bleeds | Mixed Mounting Styles |
| Cast Iron Piston Rings | Non-Rotating Cylinders |
| Electroless Nickel Plated | Proximity Switches |
| Gland Drain | Special, Rotated, or Oversize Ports |
| Key Retainers | Stainless Steel Construction |
| Low Friction Seals | Stop Tube (Indicate Total Gross) |
| Metallic Rod Scrapers | Tie Rod Extensions |

****SKETCH OUT THE MOUNT AND DIMENSIONS BELOW****

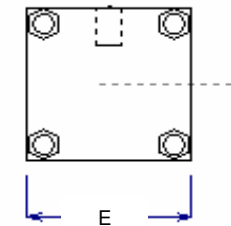
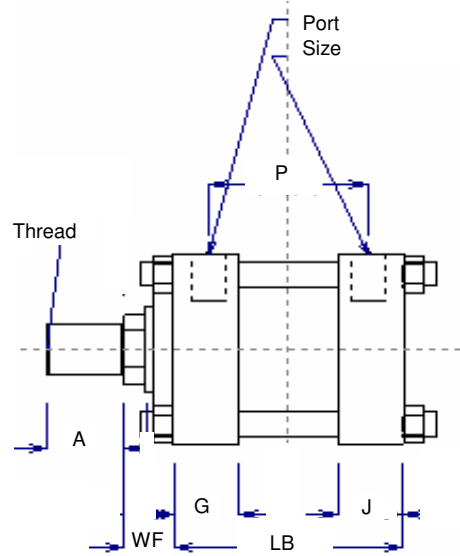

Quick Dimensions

High Pressure Hydraulic (H Series)

Standard Dimensions

Eligible Rod Sizes

Bore	E	G	J	SAE	NPT	LB + ^{stroke}	Std	Oversized				
1.5	2.50	1.75	1.50	#10	1/2"	4.63	0.625	1				
2	3.00	1.75	1.50	#10	1/2"	4.63	0.625	1				
2.5	3.50	1.75	1.50	#10	1/2"	4.75	1	1.375	1.75			
3.25	4.50	2.00	1.75	#12	3/4"	5.50	1.375	1.75	2			
4	5.00	2.00	1.75	#12	3/4"	5.75	1.75	2	2.5			
5	6.50	2.00	1.75	#12	3/4"	6.25	2	2.5	3	3.5		
6	7.50	2.25	2.25	#16	1"	7.38	2.5	3	3.5	4		
7	8.50	2.75	2.75	#20	1 1/4"	8.50	3	3.5	4	4.5	5	
8	9.50	3.00	3.00	#24	1 1/2"	9.50	3.5	4	4.5	5	5.5	
10	12.63	3.69	3.69	#32	2"	12.13	4.5	5	5.5	7		
12	14.88	4.44	4.44	#32	2 1/2"	14.50	5.5	7	8			
14	17.13	4.88	4.88	#32	2 1/2"	15.63	8	10				
16	19.25	5.88	5.88	#32	3"	18.13	8	10				
18	22.00	6.88	6.88	#32	3"	21.13	8	10				
20	23.63	7.88	7.88	#32	3"	23.63	10					

Pneumatic and Low Pressure Hydraulic (A & LH Series)

Standard Dimensions

Eligible Rod Sizes

Bore	E	G	J	NPT	SAE	LB + ^{stroke}	Std	Oversized				
1.5	2.00	1.50	1.00	3/8"	#6	3.63	0.625	1				
2	2.50	1.50	1.00	3/8"	#6	3.63	0.625	1	1.375			
2.5	3.00	1.50	1.00	3/8"	#6	3.75	0.625	1	1.375	1.75		
3.25	3.75	1.75	1.25	1/2"	#8	4.25	1	1.375	1.75	2		
4	4.50	1.75	1.25	1/2"	#8	4.25	1	1.375	1.75	2		
5	5.50	1.75	1.25	1/2"	#8	4.50	1	1.375	1.75	2		
6	6.50	2.00	1.50	3/4"	#12	5.00	1.375	1.75	2	2.5		
7	7.50	2.00	1.50	3/4"	#12	5.13	1.375	1.75	2	2.5		
8	8.50	2.00	1.50	3/4"	#12	5.13	1.375	1.75	2	2.5		
10	10.63	2.25	2.00	1"	#16	6.38	1.75	2	2.5	3	3.5	
12	12.75	2.25	2.00	1"	#16	6.88	2	2.5	3	3.5	4	
14	14.75	2.75	2.25	1 1/4"	#20	8.13	2.5	3	3.5	4		